

Disposable Medical 3-Ply Face Mask Spec

Disposable Medical 3-ply Mask Descriptions:

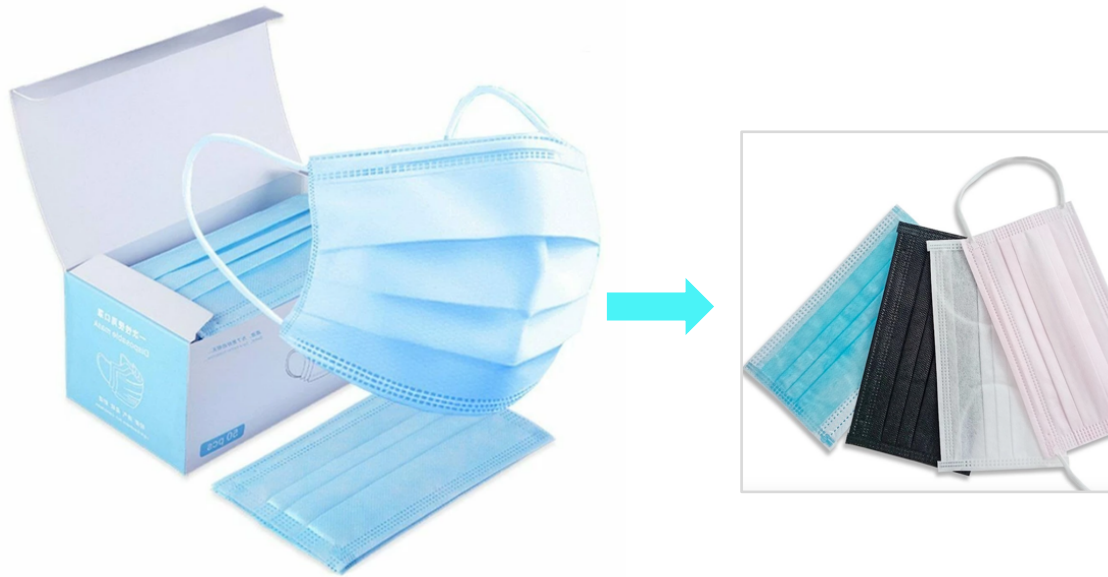

3 Layer construction: made of non-woven fiber fabric with 3 layer, soft and breathable, provides a effective protect; They are hypoallergenic, non-toxic and suitable for sensitive skin with zero chemical smell for your comfort and enjoyment.

Ergonomic design: with good elastic ear-loop, which can be adjusted its tightness; One size for most adult men or women. Our earloop face mask also offer a flexible nose piece that helps form a closure for better protection against exposure. Excellent gift for health - 50 pack disposable dust proof face mask is wonderful for family and friends, reduce the respiratory problems, give them better protection.

Multi Usage: High weaving professional surgical mask is suitable for hospital care, allergy mask, sanitary masks, pollen mask, hospital masks, procedure mask, gardening work, dental clinic, pet grooming, nail shop, home cleaning, sanitary masks, surgical, flu, dust protectors, dentists, salons, general maintenance etc.



HEALTHY LIFE SAFTY PROTECTION

Features:

- Made of no-woven fiber fabric , 3-layer, soft and breathable.
- Good filtration efficiency and low breathing resistance
- Adjustable nose clip
- Easy To Store Due To Flat design
- Blocking dust , and droplet.
- Usage Time : It is recommended to change to a new one after 4 hours
- High elastic ear-loop, absorb sweat and not tight
- Color : light blue/pink/black/white
- Main Materials: Non-woven Fabric & melt-blown fabric
- Size: Standard size for adult
- Standard: GB2626-2006 KN95
- Warranty:5years



Medical 3-ply Functions:

- Personal Respiratory Protection
- Anti-Coronavirus
- Anti-droplet transmission
- Anti-influenza Virus
- Anti-dust
- Anti-PM2.5 pollution particles
- Anti-smog
- Anti-bacteria
- Anti-pollen
- Anti-water(outer surface)



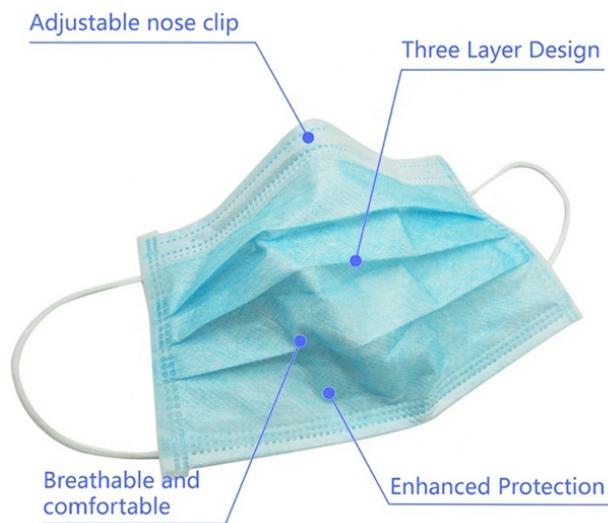

1.First deep side of the face, with a nose side up, with both hands on both sides of the mask distraction, were hung on the ears.



2. The mask down to pull down, so that the mask completely cover the face, press the shape of the nose, so that better sealing effect.

Specifications:

- Material : Non-woven fiber fabric & Melt-blown fabric
- Color : light blue(Optional)
- Quantity : 50pcs/Pack
- Item size :17*10*10cm / 6.69*3.93*3.93in
- Package weight :200g/pack
- Package Size :17.5*10.5*10.5cm
- One size fits most people
- One pack contains 50pcs.

Application scope :

- Can be used to prevent inhalation of organisms in the air and prevent droplet transmission during infectious disease epidemics and Public health emergency period
- Can be used to protect ordinary people during Epidemic period, Protection of allergic people from pollen inhalation, suitable for ordinary people engaged in Industrial work, office daily working , catering services, food processing, schools , decoration, outdoor cycling, traveling etc.